

# Outdoor Energy-Saving LED Screen

**ES-960-Series**



HD resolution



Front Maintenance



Dual system

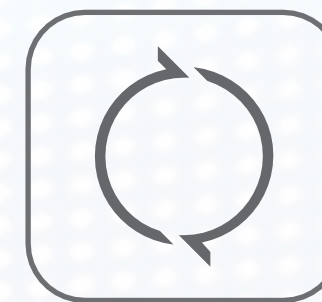

High refresh rate



Fast installation



Wide Viewing-angle



Silent operation

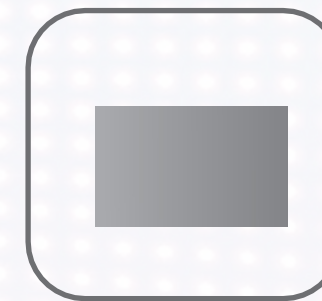

High Contrast Ratio

## Low Power Consumption & Zero Heat

1. Low energy consumption: 2.8/3.8V dual-channel separate power supply mode, common cathode circuit, improve power supply efficiency and reduce energy consumption.
2. Low temperature rise: Energy-saving driver IC is used, low temperature rise effectively reduces the temperature inside the screen, reduces the probability of damage to the LED screen, and extends the life.
3. Perfect display: high grayscale, high refresh rate (3840HZ), large viewing angle.



**LEISINO**

# Aluminum Die-casting Cabinet



# Dimension

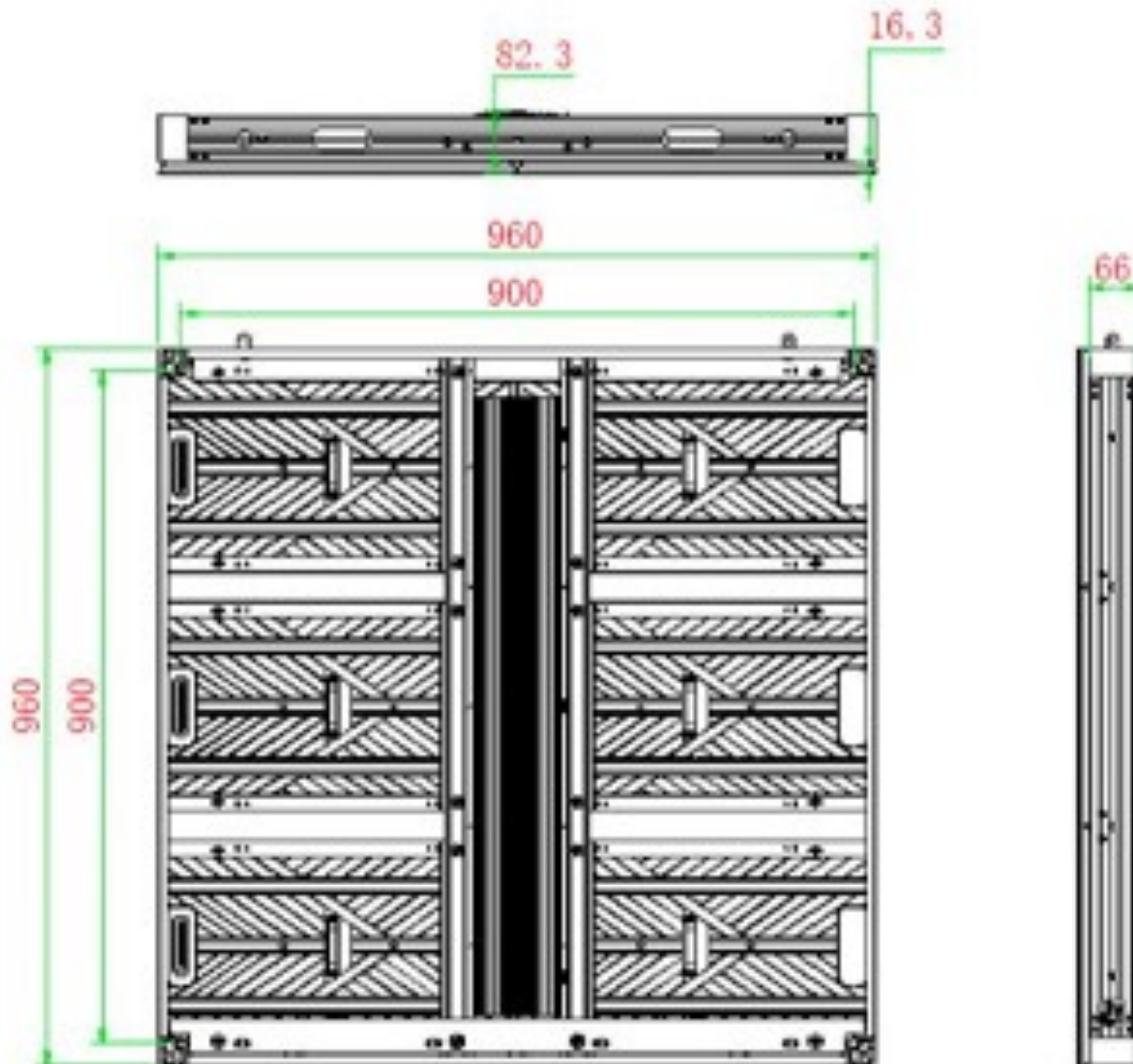

## Front maintenance

Easy to change module

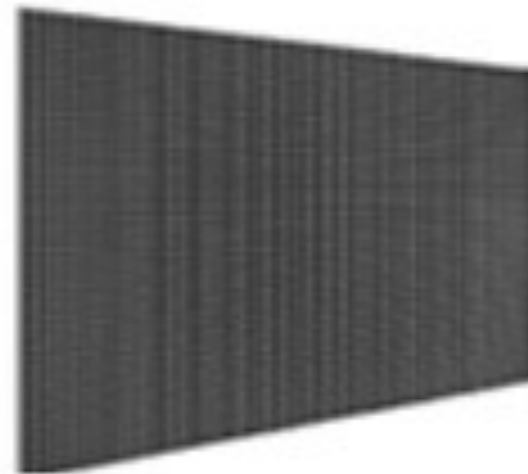

**LEISINO**

**Light Weight**



**26<sub>kg</sub>**



## Seamless Splicing

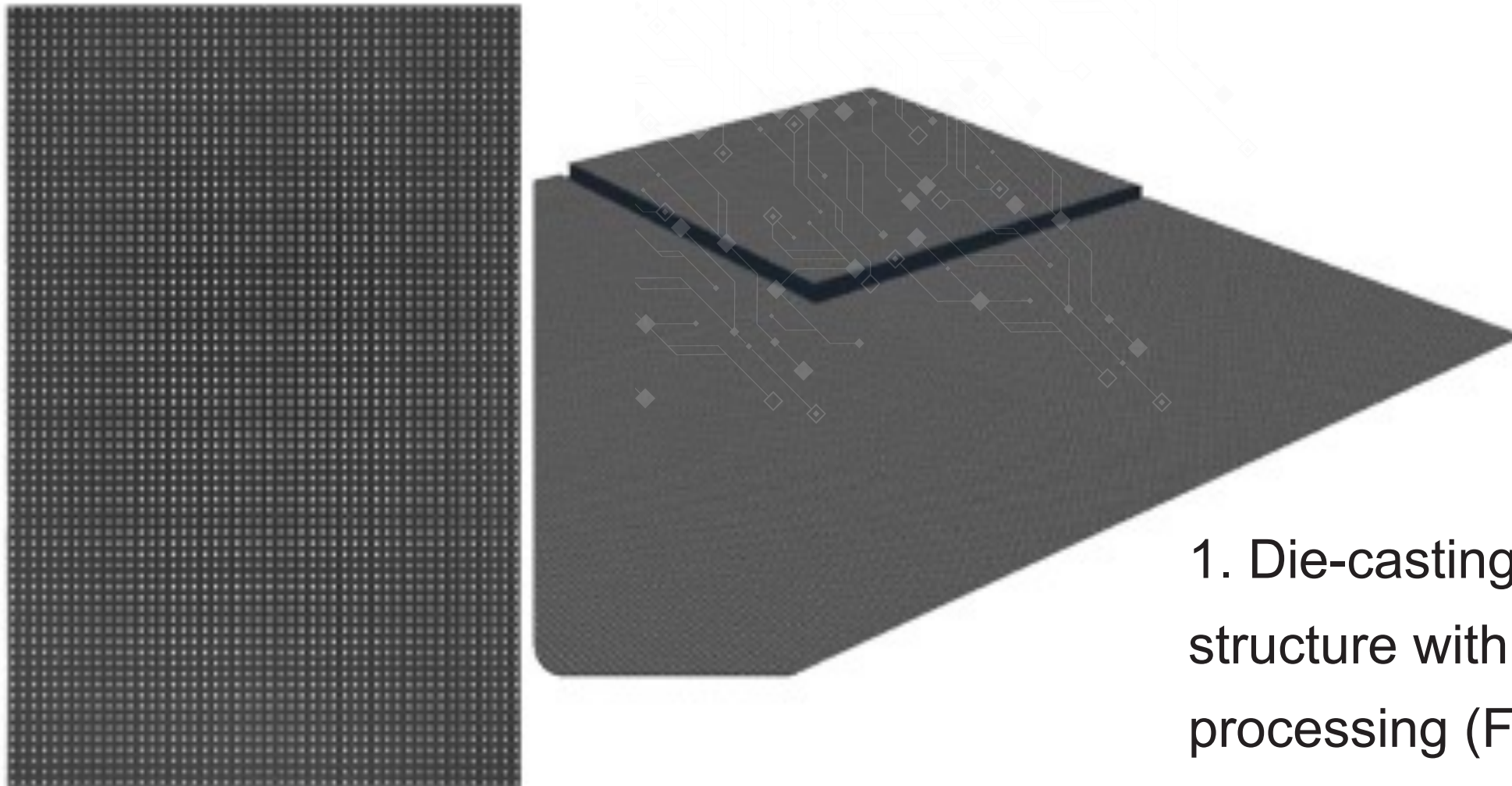

1. Die-casting aluminum cabinet structure with CNC high-precision processing (Flatness of Cabinet $\leq$ 0.1mm);
2. Screwless design for faster and more secure installation;
3. Super silent finless design.





Fast lock



Hidden Handle



Fast lock

## PRODUCT INSTALLATION

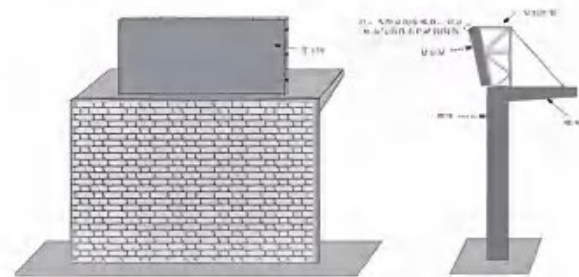

Top floor installation

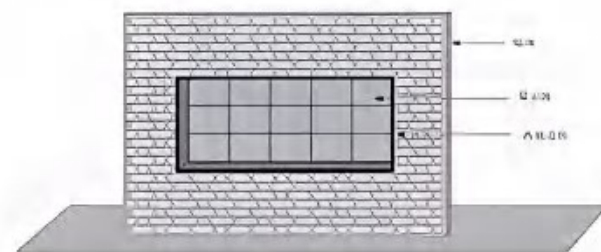

Inline installation

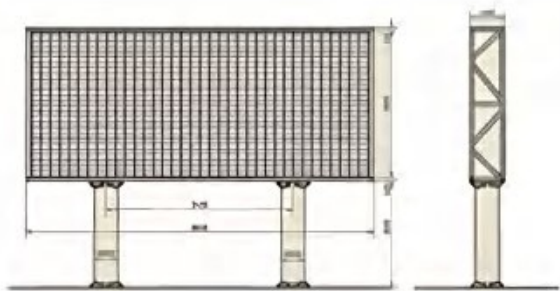

Double column support installation

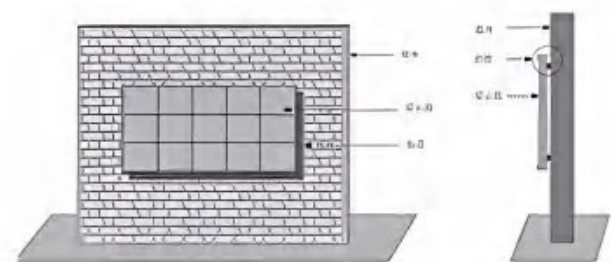

Wall mounting

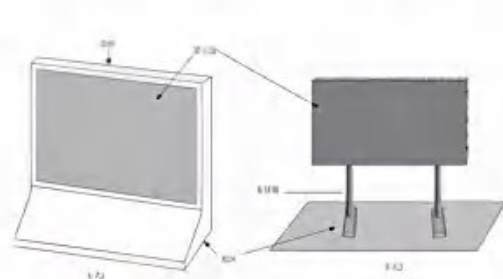

Standing and installing



Upside down installation

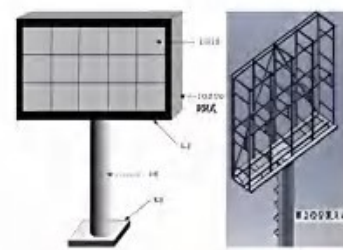

Single column installation

## Installation Mode

- Wall mounted/embedded installation/lifting
- Floor mounted/curved mounted



Stick to the wall

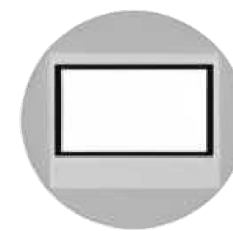

mosaic

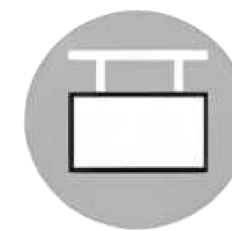

hoisting

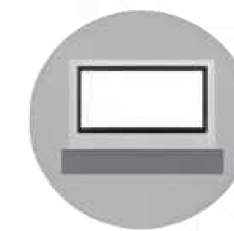

Floor mounted



Curved installation

## Wide color gamut +HDR

High color coverage, precise reproduction of natural colors, making the picture more realistic

HDR can reproduce the high peak of High dynamic range imaging and display more details



Seamless splicing of cabinets to create 2K, 4K, 8K, 16K ultra-high-definition led screens.



8K

4K

2K

High refresh rate

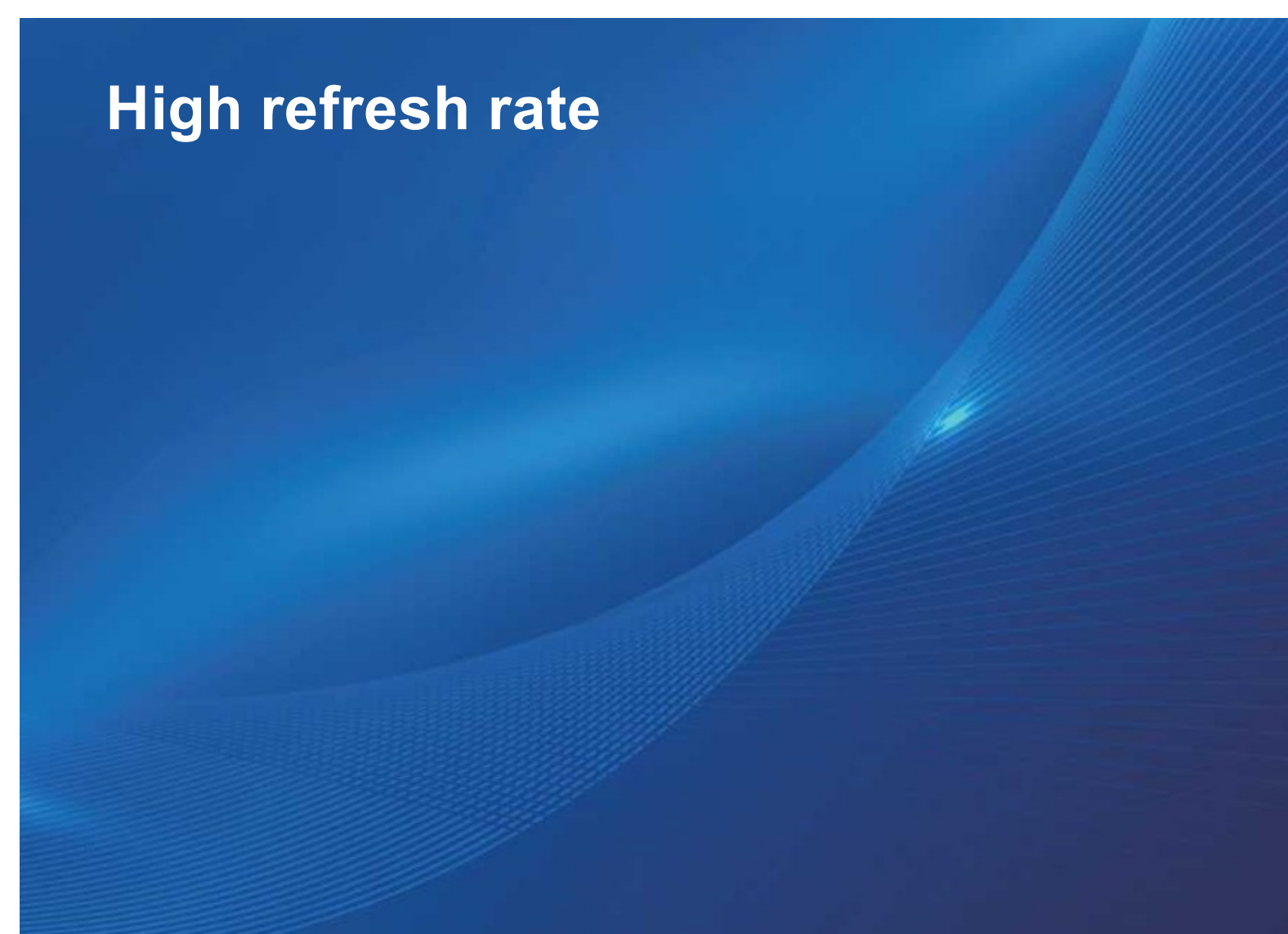

Low refresh rate



Hig grey scale



Low grey scale



LEDSINO

# 170° Super wide viewing angle

Perfect presentation of images from any angle



**Pixel Pitch****P4.44****P5.57****P6.67****P8**

Packaging type	Inversion	Inversion	Inversion	Inversion
Physical density(Dot/sqm)	51650	32230	22478	15625
Module resolution	108*72	84*56	72*48	60*40
Module size(mm)	480*320	480*320	480*320	480*320
Panel Dimension (WXHxD/mm)	960X960X120	960X960X120	960X960X120	960X960X120
Panel Resolution	216*216	168*168	144*144	120*120
Module QTY(WXH)	2 X 3	2 X 3	2 X 3	2 X 3
Panel weight(kg)	25	25	25	25
Maintenance Mode	Front maintenance	Front maintenance	Front maintenance	Front maintenance
Cabinet Material	Aluminum Profile	Aluminum Profile	Aluminum Profile	Aluminum Profile
Module Bottom Material	Dissipation Aluminum	Dissipation Aluminum	Dissipation Aluminum	Dissipation Aluminum
Brightness(Nits)	≥5000-6000	≥5000-6000	≥5000-6000	≥5000-6000
Color temperature(K)	1000-18500 Optional	1000-18500 Optional	1000-18500 Optional	1000-18500 Optional
Viewing angle(V/H)	160°/160°	160°/160°	160°/160°	160°/160°
Brightness/Color uniformity	≥99.8%	≥99.8%	≥99.8%	≥99.8%
Contrast ratio	10000 : 1	10000 : 1	10000 : 1	10000 : 1
Frame frequency	60	60	50/60	50/60
Drive mode	1/8 scans	1/7 scans	1/6 scan	1/4 scan
Grey level	16bit	16bit	16bit	16bit
Refresh rate(Hz)	3840	3840	3840	3840
Max. power consumption(W/sqm)	700	510	520	520
Avg. power consumption(W/sqm)	200	150	150	150
Protection level	IP65	IP65	IP65	IP65
Power input	AC90-264V,47-63Hz			
Working temperature/humidity(°C/RH)	-10~60°C/10%~85%			

# Case studies





# Case studies





LEDSINO

# THANKS



SHENZHEN LEDSINO OPTOELECTRONIC CO., LTD.

*Web: [https:// www.ledsino.com](https://www.ledsino.com)*

*Tel: 0086-13421345624; Email: [manager@ledsino.com](mailto:manager@ledsino.com)*

*Add: Building D, Hongfa Science Park, 2035 Songbai Road, Shiyan, Bao'an District, Shenzhen, Guangdong, China.*

