

# Outdoor LED Display (3D Visual)

**FV-960-Series**



HD resolution



Front Maintenance



Dual system

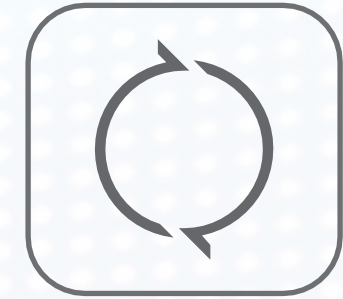

High refresh rate



Fast installation



Wide Viewing-angle

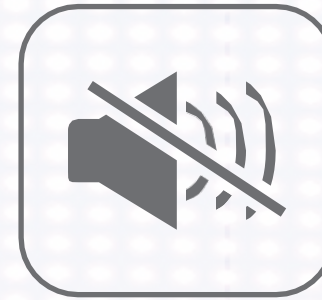

Silent operation

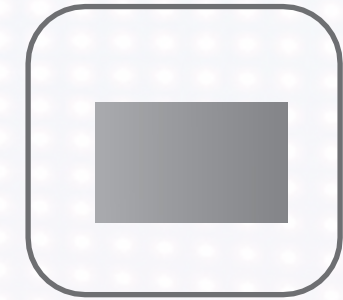

High Contrast Ratio



- Standard Modules Front/Rear Service
- Standard Size: 480×320/960\*960mm
- Ultralight Aluminum Profile Cabinet
- Display Can Operate at -20°C to 60°C
- 3D Visual Display Excellent Recommendation

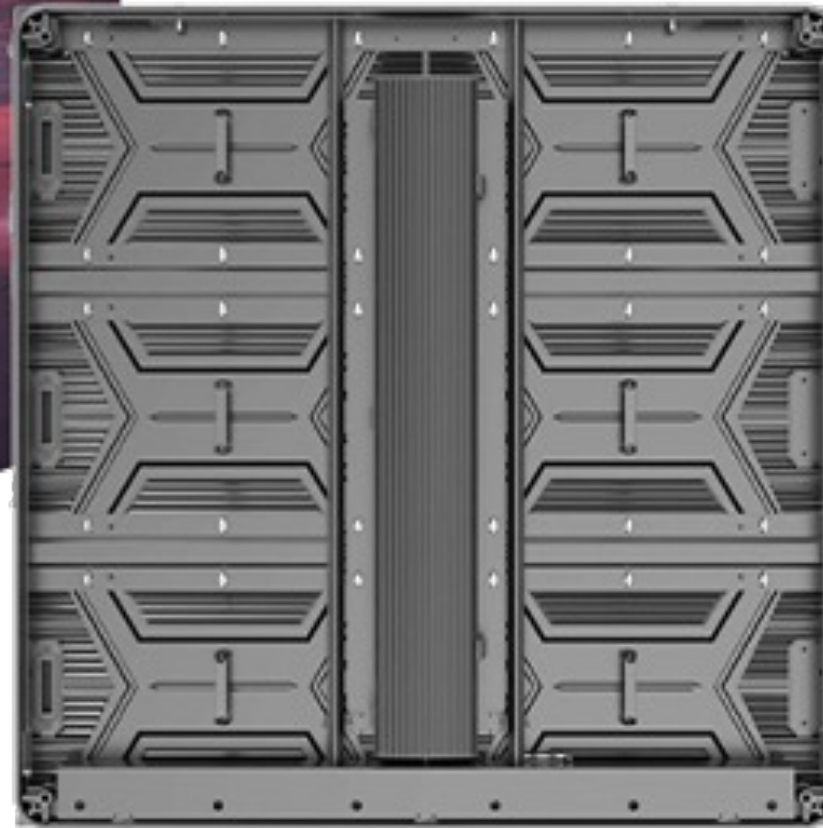

## Front Maintenance

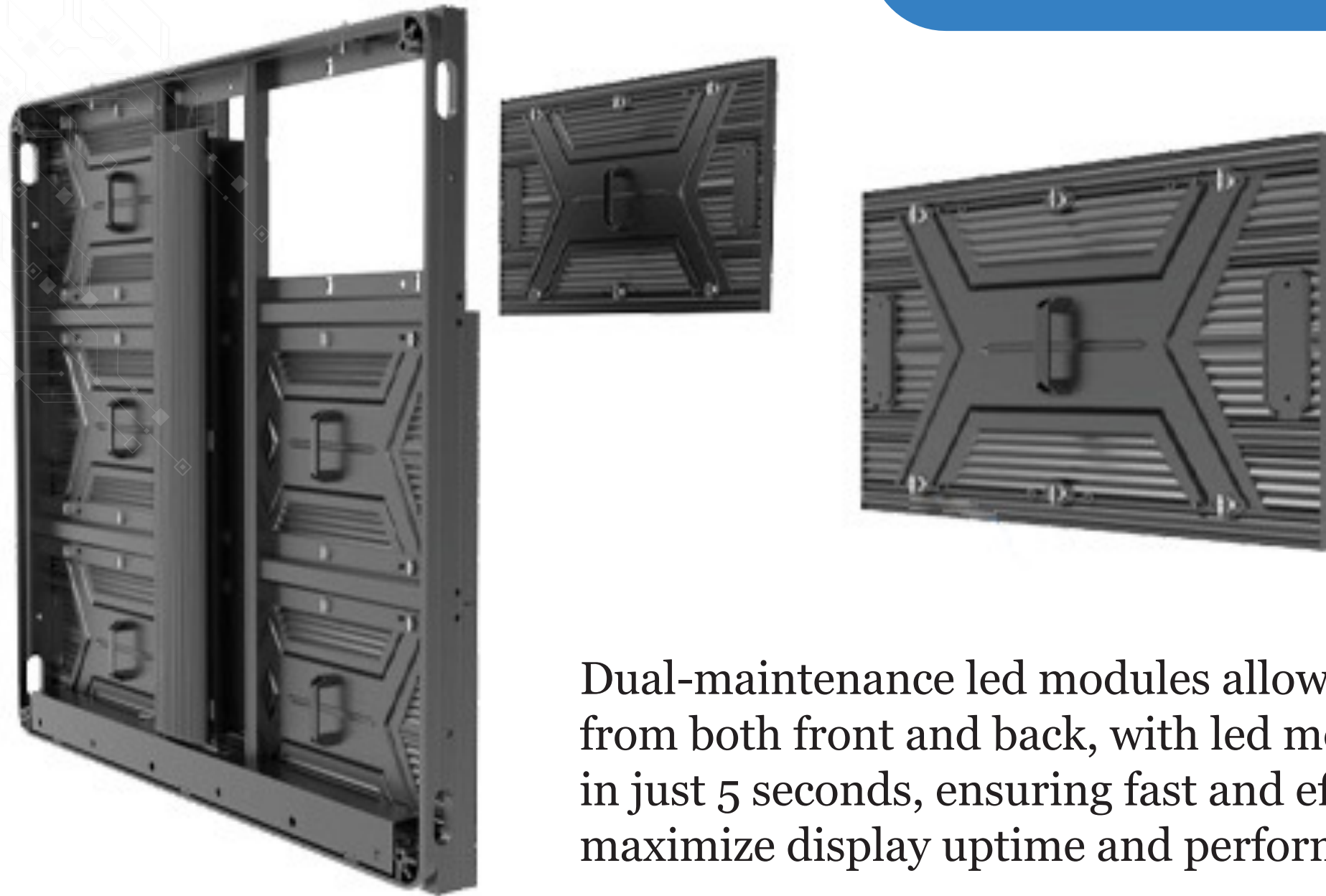

Dual-maintenance led modules allow for maintenance from both front and back, with led module replacement in just 5 seconds, ensuring fast and efficient repairs to maximize display uptime and performance.

**Sealed Standard-sized Module**

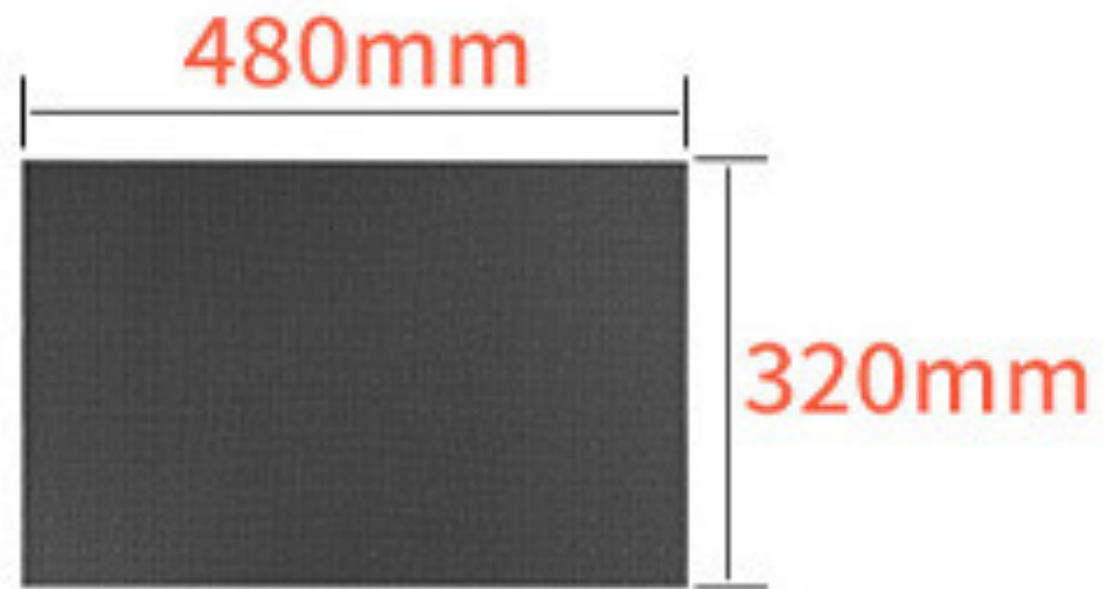
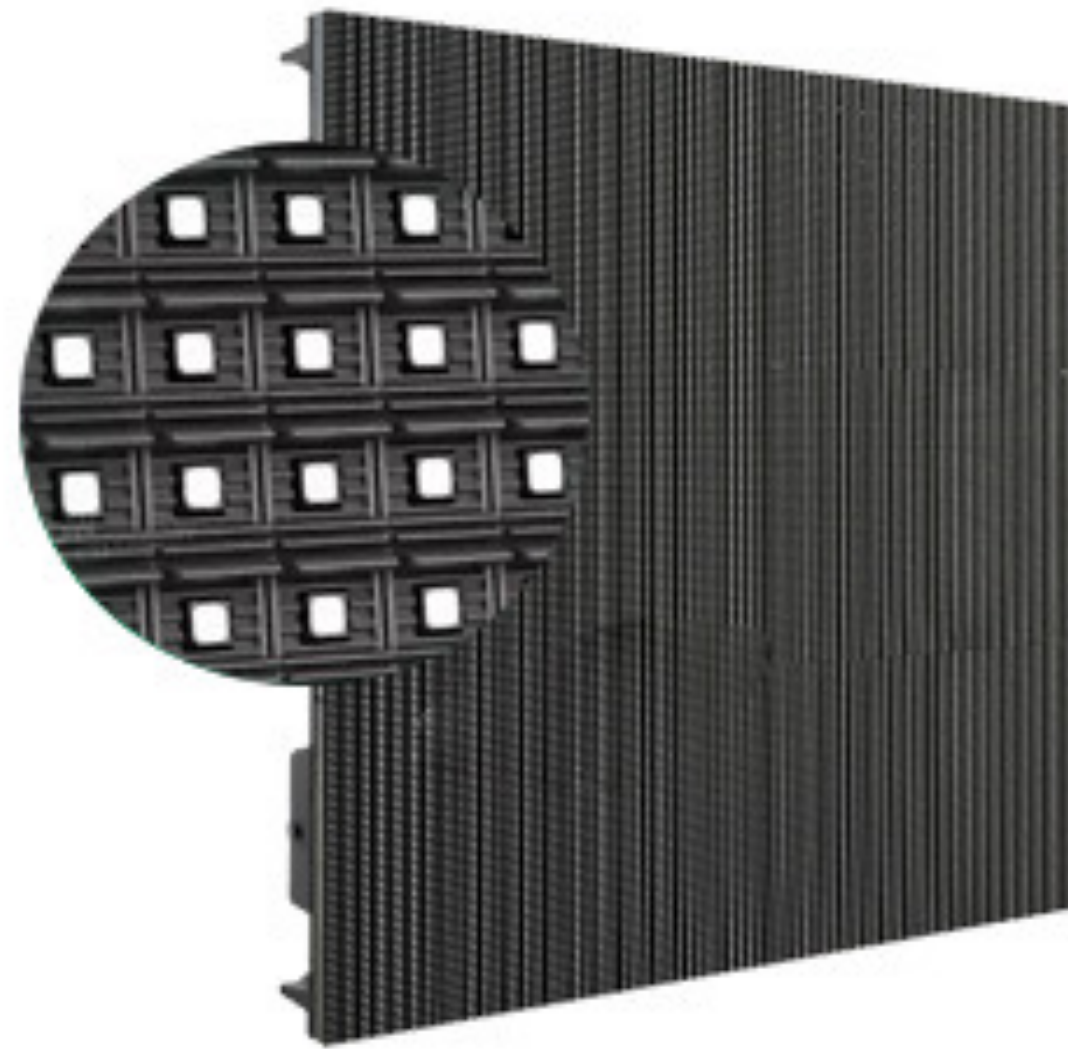

## Dimension

The 960mm\*960mm\*80mm standard aluminum profile cabinet is compatible with various led display modules. Cable groove design is used to conceal power and signal cables.

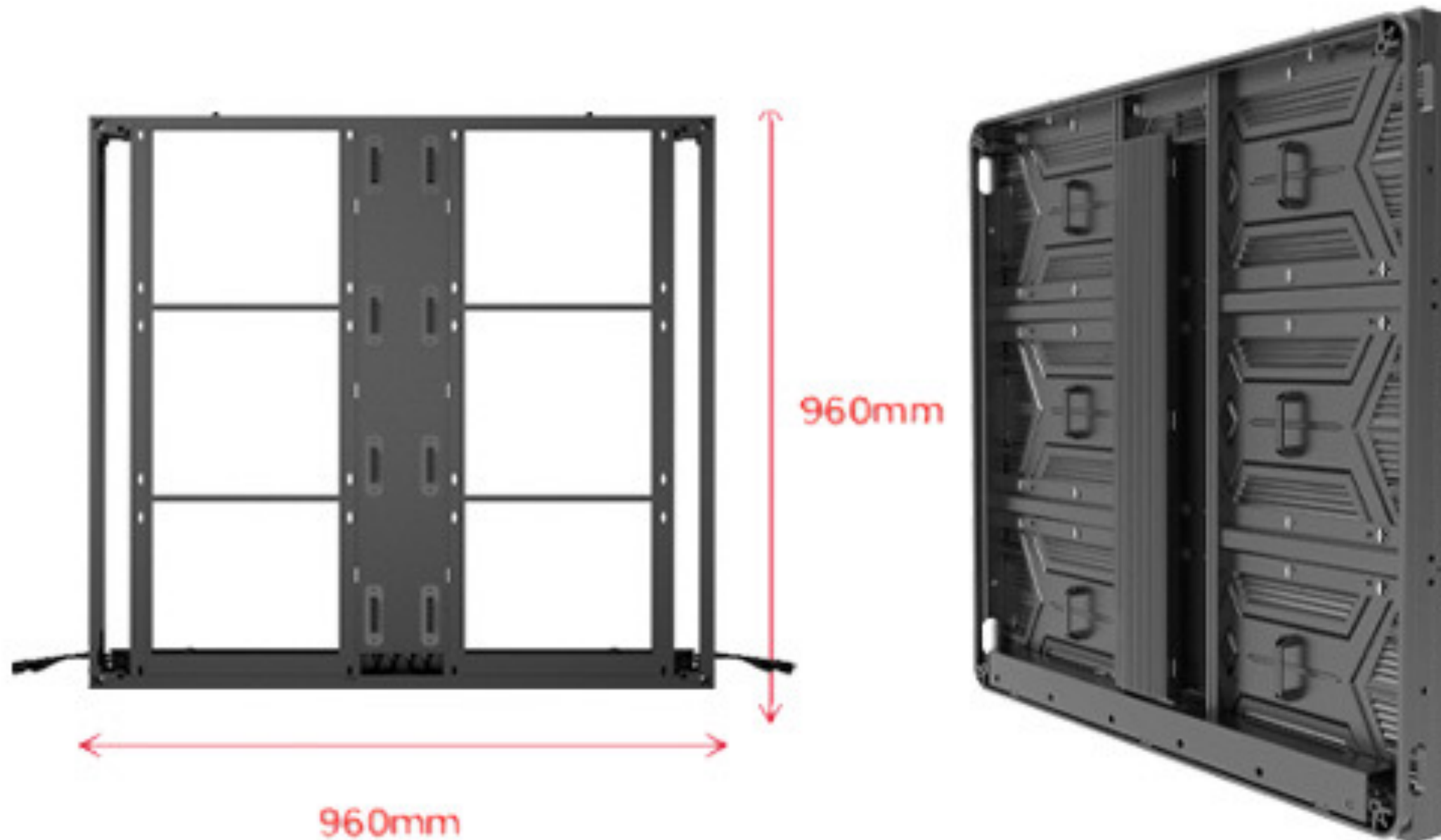

## Ultralight Aluminum Profile

The cabinet is made of ultralight aluminum profile, enables easy front installation and maintenance, saving 60cm of space compared to traditional structures and reducing weight by 60%.



LEISINO

Light Weight



26<sub>kg</sub>



## Wide 3D Visual Display

Supporting both right-angle and curved configurations, enabling seamless integration, perfect for 3D led displays, creates captivating 3D visual displays.



# LEDSINO

## Seamless Splicing



Seamless video display ensures smooth transitions between video clips or frames, providing a continuous and uninterrupted viewing experience.

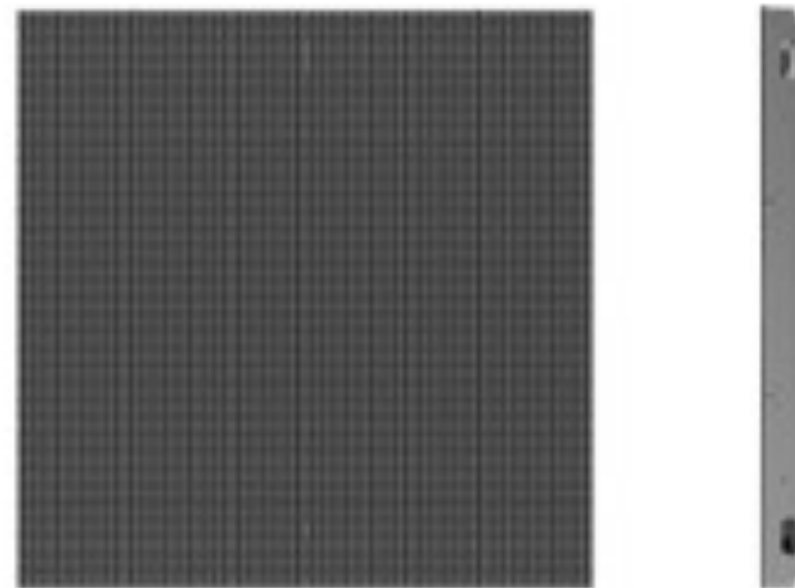

## PRODUCT INSTALLATION

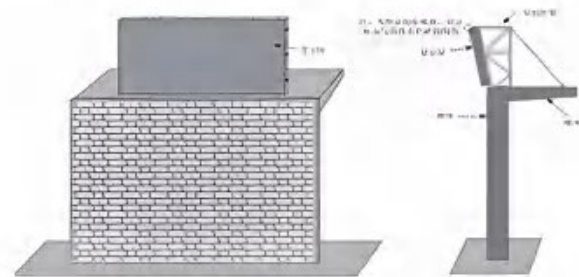

Top floor installation

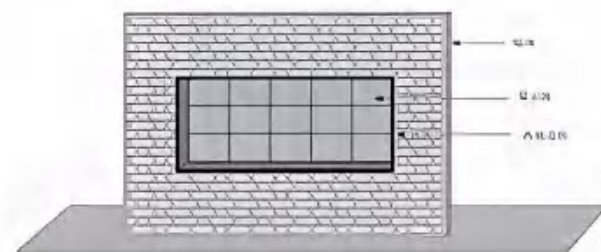

Inline installation

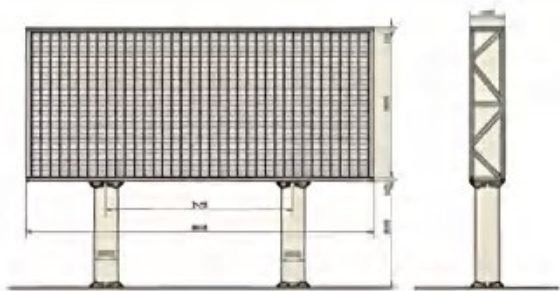

Double column support installation

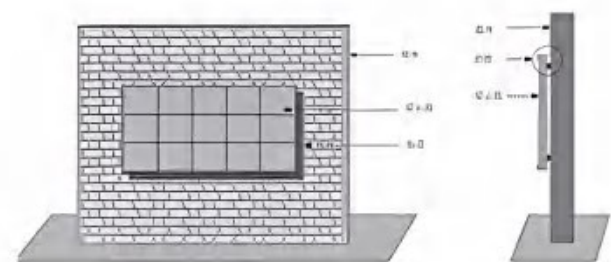

Wall mounting

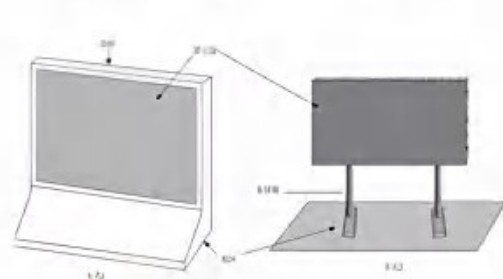

Standing and installing



Upside down installation

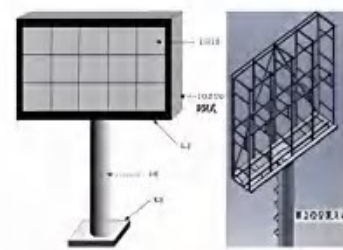

Single column installation

## Installation Mode

- Wall mounted/embedded installation/lifting
- Floor mounted/curved mounted

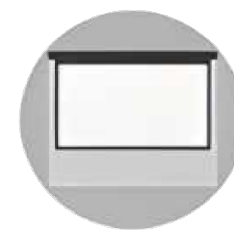

Stick to the wall

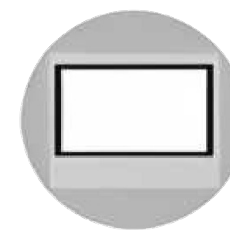

mosaic

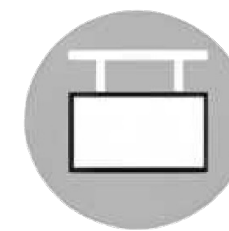

hoisting

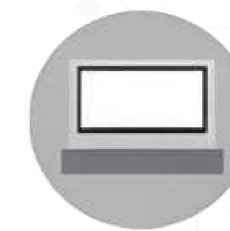

Floor mounted



Curved installation



Seamless splicing of cabinets to create 2K, 4K, 8K, 16K ultra-high-definition led screens.



8K

4K

2K

High refresh rate

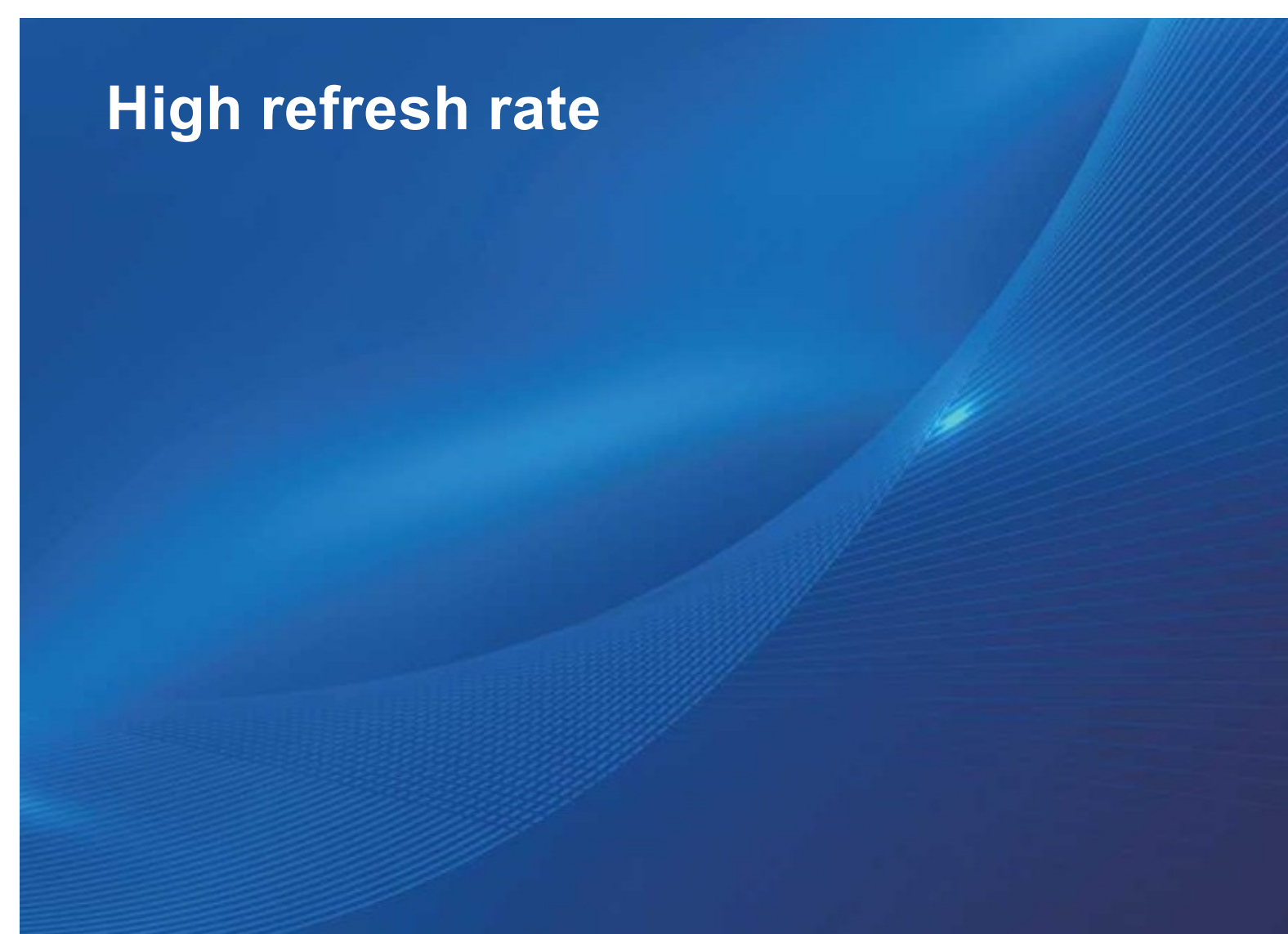

Low refresh rate



Hig grey scale



Low grey scale



LEDSINO

# 170° Super wide viewing angle

Perfect presentation of images from any angle



**Pixel Pitch****P4.44****P5.57****P6.67****P8**

Packaging type	Inversion	Inversion	Inversion	Inversion
Physical density(Dot/sqm)	51650	32230	22478	15625
Module resolution	108*72	84*56	72*48	60*40
Module size(mm)	480*320	480*320	480*320	480*320
Panel Dimension (WXHxD/mm)	960X960X120	960X960X120	960X960X120	960X960X120
Panel Resolution	216*216	168*168	144*144	120*120
Module QTY(WXH)	2 X 3	2 X 3	2 X 3	2 X 3
Panel weight(kg)	26	26	26	26
Maintenance Mode	Front maintenance	Front maintenance	Front maintenance	Front maintenance
Cabinet Material	Aluminum Profile	Aluminum Profile	Aluminum Profile	Aluminum Profile
Module Bottom Material	Retardant Plastics	Retardant Plastics	Retardant Plastics	Retardant Plastics
Brightness(Nits)	≥5000	≥5000	≥5000	≥5000
Color temperature(K)	1000-18500 Optional	1000-18500 Optional	1000-18500 Optional	1000-18500 Optional
Viewing angle(V/H)	140°/160°	140° /160°	140°/160°	140°/160°
Brightness/Color uniformity	≥99.8%	≥99.8%	≥99.8%	≥99.8%
Contrast ratio	10000 : 1	10000 : 1	10000 : 1	10000 : 1
Frame frequency	60	60	50/60	50/60
Drive mode	1/8 scans	1/7 scans	1/6 scan	1/4 scan
Grey level	16bit	16bit	16bit	16bit
Refresh rate(Hz)	1920	1920	1920	1920
Max. power consumption(W/sqm)	700	510	520	520
Avg. power consumption(W/sqm)	200	150	150	150
Protection level	IP65	IP65	IP65	IP65
Power input	AC90-264V,47-63Hz			
Working temperature/humidity(°C/RH)	-10~60°C/10%~85%			

# Case studies





# Case studies





LEDSINO

# THANKS



SHENZHEN LEDSINO OPTOELECTRONIC CO., LTD.

*Web: [https:// www.ledsino.com](https://www.ledsino.com)*

*Tel: 0086-13421345624; Email: [manager@ledsino.com](mailto:manager@ledsino.com)*

*Add: Building D, Hongfa Science Park, 2035 Songbai Road, Shiyan, Bao'an District, Shenzhen, Guangdong, China.*

